

SX3CT OSCILLATOR



Specifications

| Parameters | Standard | Options |
|--------------------------------|--------------------------------|--------------------------------|
| Frequency range | 10,0 MHz - 30,000 MHz | |
| Logic output | HCMOS | |
| Frequency stability | | |
| Initial at 25°C | ± 2.0 ppm | ± 0.5 ppm best possible |
| Temperature | ± 3.0 ppm | |
| vs supply voltage change | ± 0.3 ppm | |
| vs load change | ± 0.3 ppm | |
| Aging first year | ± 1.0 ppm | |
| Operating temperature | 0° C ~ +70°C | -20°C ~ +70°C |
| | | -30°C ~ +75°C |
| | | Other on custom request |
| Storage temperature | -40°C ~ +85°C | -55°C ~ +125°C |
| Supply voltage | 3,3 V ± 5% | 2,8 V , 3,0 V , 5,0 V |
| Current | 20,0 mA max | |
| Duty Cycle | 45 / 55 % | |
| Rise/fall times | 6 ns max. | |
| Load | 15 pF | |
| Jitter | Please specify (if required) | |
| Phase noise | | |
| Harmonics | | |
| Sub-harmonics | | |
| Start-up time | 5 ms max. | Other on custom request |
| Marking | Freq + Code + Week +Year | |
| Voltage Control Options | | |
| External control voltage | +1,5 VDC ±1,0 VDC | Other on custom request |
| Linearity | ± 10% max. | |
| Frequency tuning range | ± 5 ppm min | Other on custom request |
| Pulling slope | Positive | |

SX3CT OSCILLATOR

Specifications

Drawing

Package

SX3

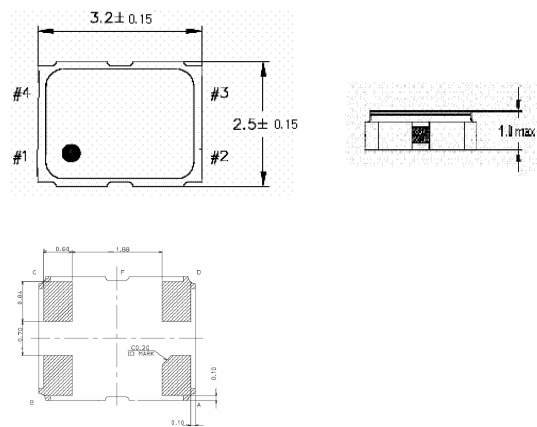

pin configuration

#1 : NC or V_{co}

#2 : GND

#3 : Output

#4 : V_{cc}